

LT-LA-140220-1860-05
Low Noise Amplifier
WR-05/140-220GHz/6.0 NF/18dB Gain
sales@lauftek.ru | lauftek.ru



LT-LA-140220-1860-05 is a G-Band low noise amplifier with small signal gain of 18 dB and a nominal noise figure of 6.0 dB across the frequency range of 140 to 220 GHz. The DC power requirement for the amplifier is +12 VDC/50 mA. The input and output port configuration offers an inline structure with WR-05 waveguides and UG-387/U-M anti-cocking flanges.

Features:

- Frequency range:140-220GHz
- Gain: 18dB Min
- Noise Figure: 6.0dB Typ
- Unconditional stability

Applications:

- Passive Imaging
- 5G Systems

Electrical Characteristics:

Parameter	Min	Typ	Max	单位 Units
Frequency range	140		220	GHz
Gain	18			dB
Noise Figure		6		dB
Output Psat		0		dBm
Input VSWR		3.5		:1
Output VSWR		3.5		:1
DC Voltage		12		V DC
DC power supply		50		mA

Mechanical Specifications:

Parameter	Value	Units
Input Connector	WR-05/ UG-387/U	
Output Connector	WR-05/ UG-387/U	
Power Supply Pin	Solder Pin	
Size	30*30*23	mm

Absolute Maximum Ratings:

Parameter	Value
Supply Bias Voltage	+15 V
RF Input Power	-5 dBm
ESD sensitivity (HBm)	Class 0, passed 150V

Outline Drawing: Unit:mm

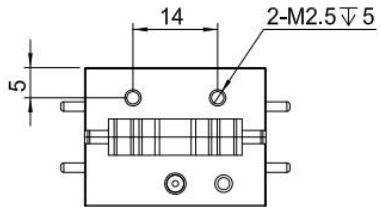
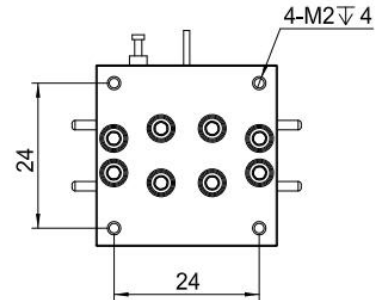
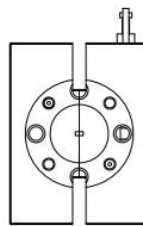
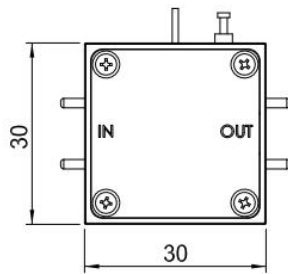
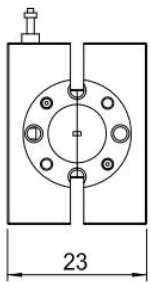
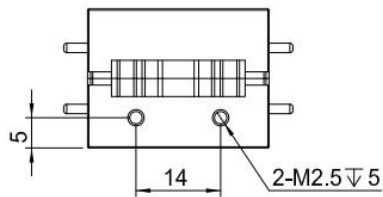

Environmental Conditions:

Parameter	Min	Typ	Max	Units
Operating Temperature	-10		+65	°C
Non-operating Temperature	-45		+85	°C
Relative humidity		95		%
Altitude	10,000			feet
Shock / Vibration(MIL-STD-810F)	25g rms (15 degree 2KHz) endurance, 1 hour per axis			
Shock(non operating)	20G for 11msc half sin wave,3 axis both directions			

Typical Performance Data:

Gain vs Frequency

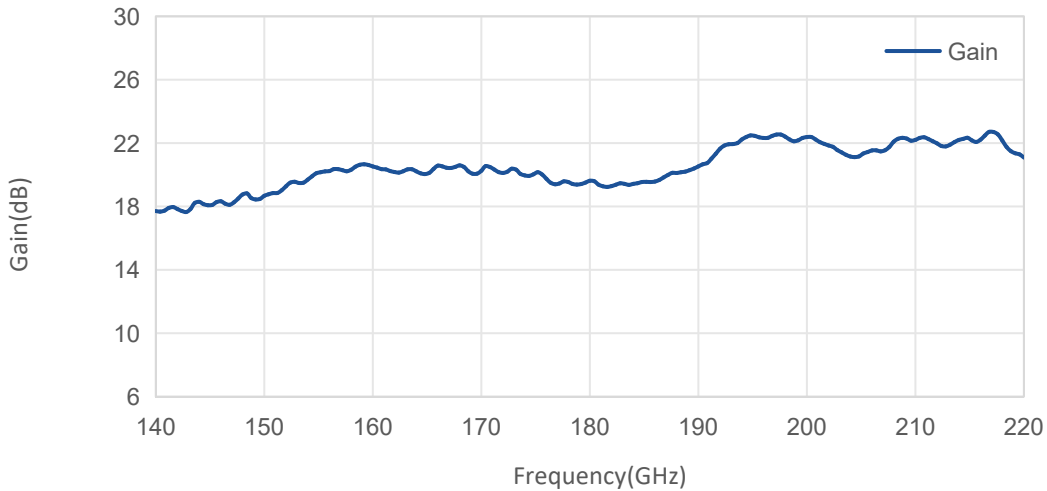

Note: Above data is for ref only, actual data may vary from unit to unit depending on operating environment and other factors like material lots etc.

Typical Performance Data:

Noise Figure vs Frequency

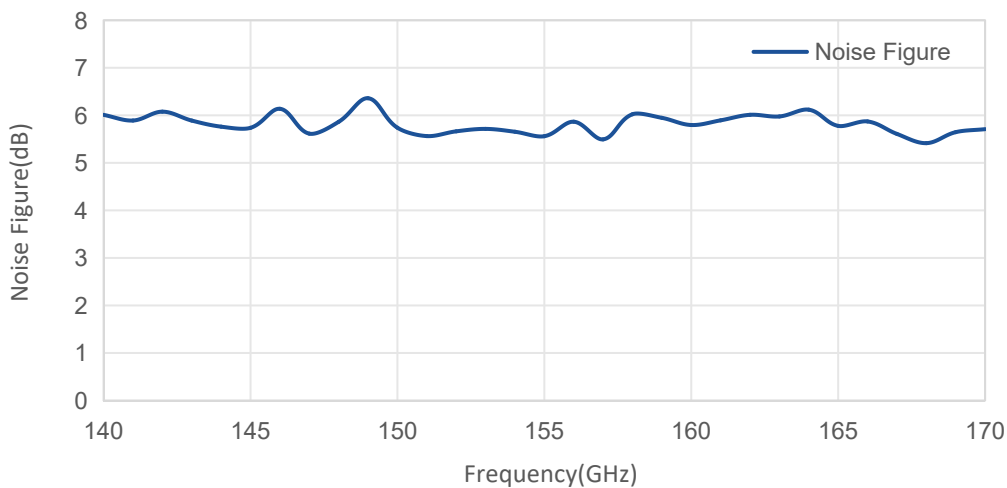

VSWR vs Frequency

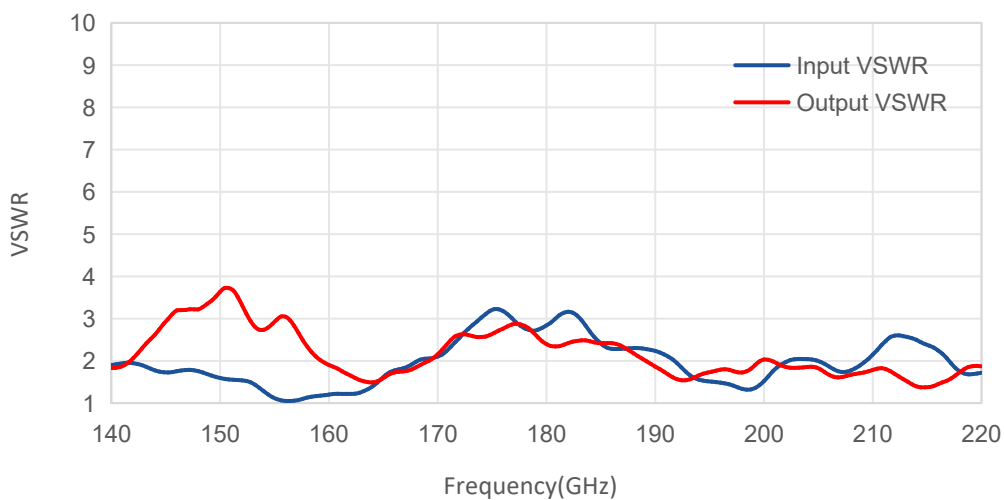

Note: Above data is for ref only, actual data may vary from unit to unit depending on operating environment and other factors like material lots etc.